



THE ROYAL PORTFOLIO

ROYAL MALEWANE

Malewane
FACT SHEET



CONTENTS

WELCOME TO MALEWANE LODGE	1
LODGES AND VILLAS MAP	2
MALEWANE LODGE MAP	3
ACCOMMODATION COMPARISON	4
LUXURY SUITE	6
ROYAL SUITE	7
BRING THE CHILDREN	8
ACTIVITIES	9
EXCURSIONS	10
GUIDES AND TRACKERS	11
SPA AND WELLNESS	12
DINING	13
WHAT TO PACK	14
COMMUNITY AND CONSERVATION	15
SUSTAINABILITY	16
GETTING TO MALEWANE LODGE	17
GOOD TO KNOW	18
ROYAL MALEWANE LODGES COMPARISON	19
CONTACT US	20

WELCOME TO
Malewane Lodge

A HAVEN OF STYLISH SPLENDOUR
WITH CONSERVATION AT THE CORE

In designing Malewane Lodge, Liz Biden has channelled timeless elegance, informed by the key touchpoints of traditional safari style.

No detail has been overlooked in creating the ultimate African experience, where wildlife encounters in the bushveld seamlessly segue into relaxed evenings.



MAIN DECK - MALEWANE LODGE

Royal Malewane Lodges and Villas



Royal Malerwane

MALEWANE LODGE & AFRICA HOUSE

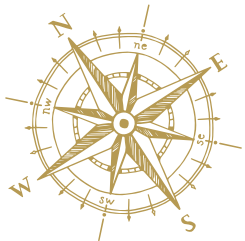
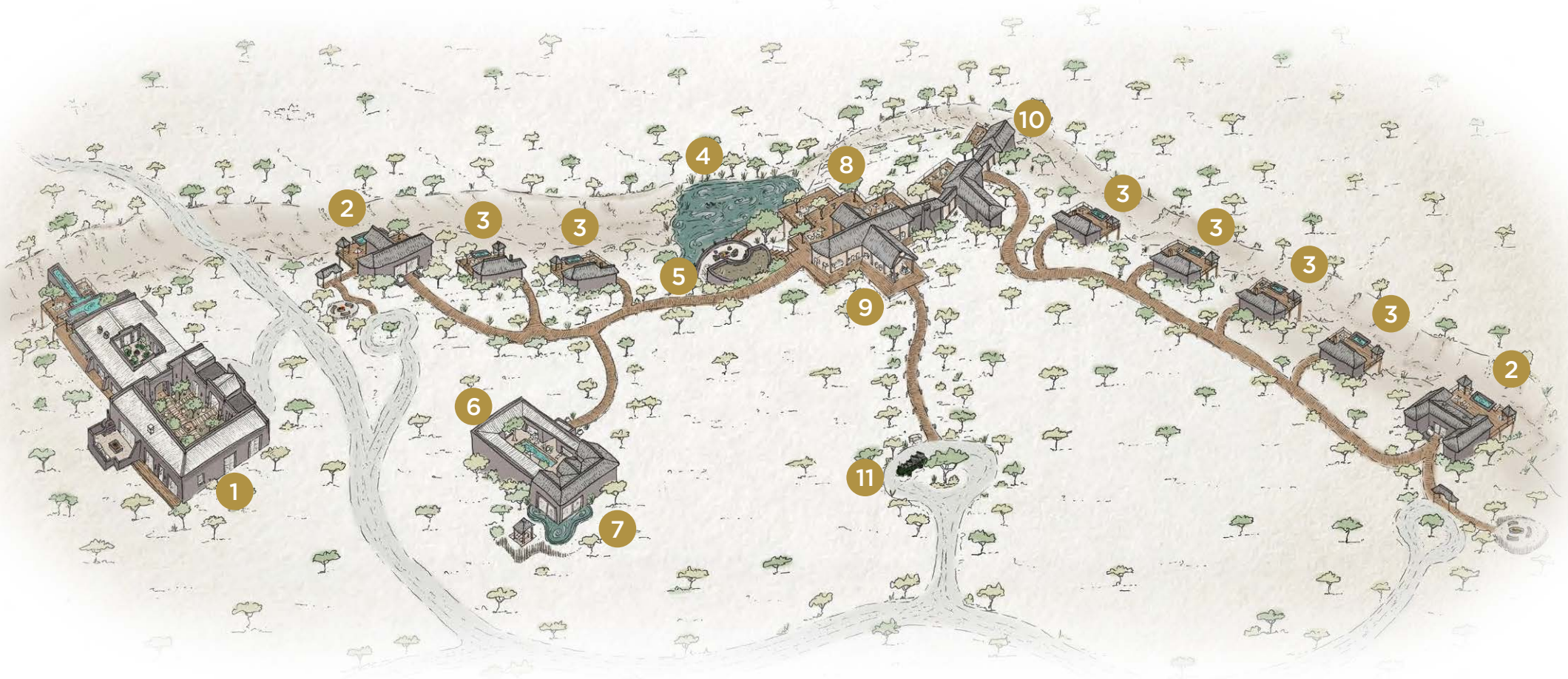

1 Africa House

2 Royal Suites

3 Luxury Suites

4 Waterhole

5 Masiya Bar

6 Gym

7 Spa

8 Dining Area

9 Reception

10 Library

11 Arrival Circle

Accommodation Comparison

FACILITIES ACCOMMODATION	MALEWANE LODGE		
	A classic bush lodge, brimming with charm and luxury. This is the original Biden Family homestead.		
	<ul style="list-style-type: none">• Reception• Boutique• Gym• Royal Waters Spa• Dining areas• Library• Masiya bar• Wine cellar		
	Sleeps a total of 20 guests		
	SUITE NAME	Luxury Suite	Royal Suite
	NO. OF SUITES	6	2
	ROOMS PER SUITE	1	2
	AGES	10 & up	All
	PRIVATE SERVICES	No	Yes





Luxury Suite

Each suite accommodates two guests and features a private wooden deck, rim-flow pool and a thatched outdoor sala. The main room contains a fireplace, beautiful dark wooden furniture and a canopied king-size bed.

The Luxury Suites are 165m² (1,780ft²) including the private deck and plunge pool. Four of the six suites have four-poster, king size beds, whilst the remaining two suites can be made into twin beds.

ALL LUXURY SUITES INCLUDE:

- Ceiling fans
- Air conditioning
- Tea and coffee making facilities
- Mini-bar
- In-room safes
- Telephones
- Smart TV
- Wi-Fi
- International adaptors and hairdryers
- Fireplace
- Private deck and plunge pool
- Outdoor sala



LUXURY SUITE

Royal Suite

Each suite accommodates up to two guests in each of the two spacious ensuite bedrooms either side of the living room and dining area. One of the two rooms has a four-poster, king size bed, whilst the second one has a king size bed that can be converted into twin beds.

The Royal Suites are 510m² (5,490ft²) including the private deck and plunge pool. Royal Suites have their own private services (private chef, host and private safari vehicle with a Guide and Tracker). Children of all ages are welcome in the Royal Suites.

BOTH ROYAL SUITES INCLUDE:

- Ceiling fans
- Air conditioning
- Underfloor heating
- Tea and coffee making facilities
- Mini-bar
- In-room safes
- Telephones
- Smart TV
- Wi-Fi
- International adaptors and hairdryers
- Lounge, fireplace, dining area with an open-plan kitchen
- Private deck and plunge pool
- Private services (private chef, host and private safari vehicle with a Guide and Tracker)



ROYAL SUITE



Bring the Children

Children of all ages are welcome in our two-bedroom Royal Suites.

THE CHILDREN WILL LOVE:

- Child-friendly game drives
- Animal checklist
- Arts & crafts
- Board games & puzzles
- Bush quiz

Our expert guides and trackers love to share their knowledge with kids of all ages and are masters at making that knowledge accessible to future rangers during game drives.

Activities

Inviting endless opportunities to reconnect and experience a sense of togetherness in this pristine natural setting, guests can choose how to spend their days.

- Twice daily game drives with the most accomplished guiding team in Africa
- Discover the finer details of the bush while on foot during a bush walk
- Soothing wellness treatments at Royal Waters Spa
- Photographic safaris
- World-class wine tastings
- Make use of the gym facilities

CONSERVATION ACTIVITIES

- Visit Royal Malewane's Conservation and Research Centre
- Rhino dehorning experience
- Helicopter patrol flight
- APNR Ground-hornbill project experience
- Elephants Alive experience
- K9 Unit demonstration
- EWT wild dog conservation experience

For more information on these conservation experiences, click [here](#). All conservation activities are subject to operational availability.



Excursions

If you feel like venturing further afield, our Reservations team can arrange the following activities at an additional charge.

- Helicopter flights over the Blyde River Canyon, the world's deepest green canyon
- Golf at Africa's most exclusive bushveld golf course – Leopard Creek
- A visit to the Timbavati Museum
- A visit to the Moholoholo Wildlife Rehabilitation Centre
- Visit Langutelani Crèche, Sigagule Crèche, or Sihlekisi Primary School in the local community, each supported by The Royal Portfolio Foundation

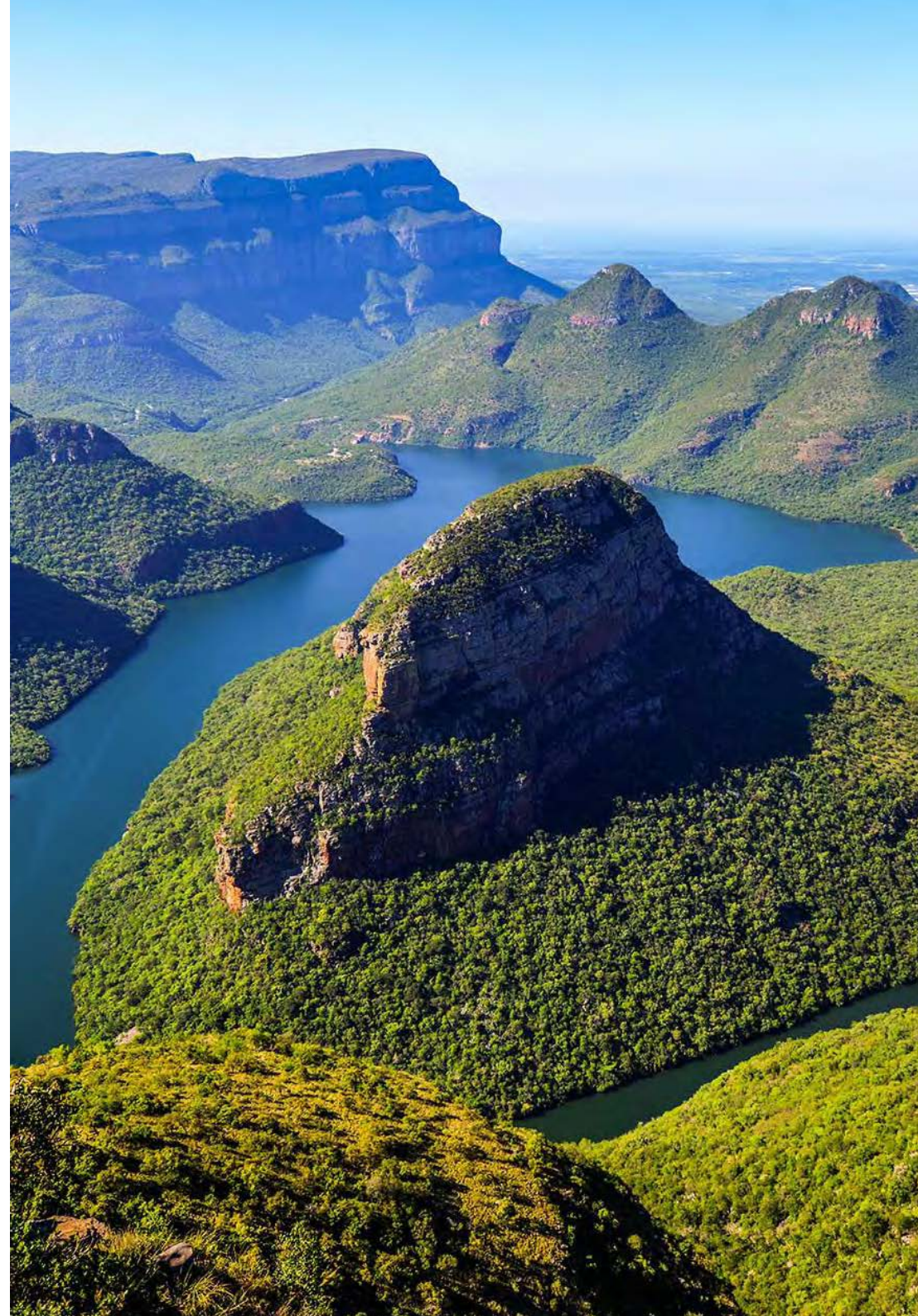

The Most Qualified Guiding Team

IN AFRICA

Royal Malewane is often referred to as the 'Harvard of the Bush'. That's because of the guiding team's unyielding passion for learning and their ambition not just to be the best, but to raise the standards of the industry as a whole. The Guides at Royal Malewane strive to achieve the highest Field Guides Association of Southern Africa (FGASA) qualifications, as well as advanced rifle handling certificates.

These qualifications ensure that you will enjoy an exceptional game-viewing experience – not only while on game drive, but also on foot during guided bush walks. At the pinnacle of the professional guiding qualifications are the Special Knowledge & Skills (SKS) Qualifications such as Dangerous Game and Birding. Very few guides in Africa achieve these qualifications which require extensive knowledge as well as technical skills - the team at Royal Malewane has these attributes in abundance.

Further to the impressive qualifications above, is the FGASA Scout status. There are only 13 Professional Field Guides with FGASA Scout status in the world, and two of those, are on the Royal Malewane team. We are also very proud to have two of only 11 living Master Trackers in the world on our team, and they are the only two working in the Greater Kruger region. Wilson Masiya, who passed away in 2015, was a legendary Master Tracker at Royal Malewane who left a remarkable guiding legacy.

Collectively, our guiding team brings over 300 years of combined African bush experience, ensuring exceptional safari experiences for our guests.





Spa and Wellness

OUR SPA AND WELLNESS TREATMENTS DRAW ON THE HEALING POWER OF NATURE, AND TRADITIONAL HERBAL WISDOM

The Royal Waters Spa at Malewane Lodge invokes the therapeutic properties of water. Treatments make use of mineral-rich water sourced from an underground stream that flows through the reserve.

THE SPA FACILITIES INCLUDE:

- 25m (82ft) heated lap pool
- Three treatment rooms (one double and two single)
- A fully equipped gym
- Steam room
- Hot and cold African baths
- Hair salon
- Four casitas



Dining

Dining at Malewane Lodge is a unique experience with a wide variety of beautiful settings in which to savour soul-stirring recipes and our handpicked selection of South Africa's finest wines.

The main dining area at Malewane Lodge overlooks a bustling waterhole, resulting in some spectacular mealtime game viewing.

Royal Malewane offers you complete dining flexibility. We can tailor a menu to your personal tastes and dietary requirements. All meals, local beverages and wines (excluding French Champagne) are included in our rates.

Bush Dinners let you feast under the stars, surrounded by the wilderness, and comforted by the glow of lanterns and a crackling fire.

Please speak to us about private chefs, our Kosher Compliant Kitchen (at an extra cost) and any dietary requirements.

| *What to Pack*

The Golden Rule to remember is that safari should always be more about comfort than style; however, it is very possible to achieve both. Pack very minimal and lightweight, clothing in neutral, earth colours. Since Royal Malewane provides laundry services, packing light should be easy.

- A good pair of walking shoes and socks (for bush walks)
- Sandals for around the lodge and in your room
- Closed shoes for the evenings
- Long sleeve and mid-sleeve cotton shirts for layering
- Shorts - two or three pairs for midday wear
- Sleeveless shirts for warmer days
- Swimming costume
- A wind breaker
- Active wear (if wanting to use our gym)
- A sun hat or two (a wide brimmed hat that has a string)
- Sunglasses and a light scarf
- High SPF sunblock and mosquito repellent
- Camera, video camera, binoculars, spare memory cards, and chargers

ADDITIONAL ITEMS TO PACK FOR WINTER:

- | | |
|--------------------------|--|
| • A warm jacket | • A beanie and scarf for morning drives |
| • Cotton shirts or vests | • A few long sleeve shirts |
| • One or two jumpers | • A few long pants |
| • Thermal undergarments | • Walking shoes, sandals and boots |
| • Winter evening wear | • A lightweight rain jacket for the rainy season |





THE CONSERVATION AND RESEARCH CENTRE

Community and Conservation

Aligned with The Royal Portfolio's ethos, Royal Malewane prioritises community upliftment and environmental conservation.

COMMUNITY

- We support community development projects
- We're committed to improving crèche and school facilities in nearby villages
- Guests have the chance to visit the local crèches and schools we support

CONSERVATION

- Thornybush's K9 anti-poaching dog unit is making the Greater Kruger area safer for wildlife
- The Royal Portfolio Foundation is committed to supporting various conservation projects in the Greater Kruger, such as the APNR Ground Hornbill Project, EWT Birds of Prey Programme and the EWT Wild Dogs Project

THE CONSERVATION AND RESEARCH CENTRE

The Royal Malewane Conservation & Research Centre (CRC) is a hub for researchers, scientists, and guests who share our passion for conservation. It is a space where professionals can share their findings through lectures and discussions.

The CRC will inform and empower our goal of preserving the Greater Kruger ecosystem; it fosters a deeper understanding of the challenges we face and how we plan to overcome them.



Sustainability

HYDRONIC HEATING AND COOLING WATER SYSTEM

At our most recently built lodges and villas, we've invested in an innovative, integrated heating system that uses solar energy and hydronics to heat water, pools, towel rails, and underfloor heating, while also powering the air conditioning.

ADDITIONAL PROJECTS

- We're reducing the amount of water we use
- We're limiting our carbon footprint by choosing energy-efficient devices
- We're phasing out plastic water bottles in favour of reusable glass bottles

GETTING TO *Malewane Lodge*

TRAVEL BY AIR

From Johannesburg (O.R. Tambo International Airport -JNB):

SA Airlink and CemAir fly daily to Hoedspruit Airport (HDS). Bookings can be made directly online.

Road transfers can be arranged by Royal Malewane and take approximately 35 minutes in a comfortable air-conditioned vehicle.

From Cape Town International Airport (CPT):

SA Airlink and CemAir fly daily to Hoedspruit Airport (HDS). Bookings can be made directly online.

Chartered Flights:

You can also charter your own flight directly to our private airstrip. Our Reservations Team can assist with domestic flights and private charters and road transfers.

AIRLINE DETAILS

CemAir:

www.flycemair.co.za/
+27 86 123 6247

SA Airlink:

www.flyairlink.com/en/za/
+27 11 451 7300



Good to Know

GENERAL

- We have a 24-hour staffed switchboard
- Babysitting services can be arranged at an additional cost
- Weddings can also be arranged at Royal Malewane
- Private safari vehicles can be arranged on request, subject to availability and at additional cost
- We accept MasterCard, Visa, Diners Club and American Express Credit Cards
- We welcome families with children aged 10 and older at the Luxury Suites. Children under 10 years are welcome at the Royal Suites

INCLUDED IN STAY

- Accommodation
- All meals & snacks
- All coffees & speciality teas
- Mini-bar
- Wi-Fi
- Laundry service
- Game drive and bush walks
- Local beverages & house wines
- Transfers to and from Royal Malewane Airstrip
- Royal Suites only - Private services (private chef, host and private safari vehicle with a Guide and Tracker)

EXCLUSIONS

- Boutique purchases
- Telephone calls
- Kosher meals
- Photographic equipment
- Conservation & Community Levy
- Transfers to and from the reserve
- Private safari vehicle (with the exception of the Royal Suites where this is included in the rate)



Royal Malewane Lodges Comparison

MALEWANE LODGE

A classic and traditional bush-style lodge, brimming with old-world elegance and timeless luxury. This is the original Biden Family homestead.

- Sleeps 20 guests across six Luxury Suites and two Royal Suites
- All suites enjoy direct access to Malewane Lodge's reception, dining areas, library, spa and gym via illuminated pathways
- Guide's room available
- Masiya bar and Wine Cellar
- The Royal Waters Spa
- Luxury Suites welcome children over 10 years old
- Royal Suites welcome children of all ages and offer private services

FARMSTEAD

A contemporary-style lodge with sweeping vistas over the bushveld. A more intimate and private space that is both stylish and comfortable.

- Sleeps 6 guests across three Luxury Farm Suites
- All suites enjoy direct access to Farmstead's reception, dining area, treatment room, gym and The Farmhouse via illuminated walkways
- Guide's room available
- Communal bar
- Treatment room
- Luxury Farm Suites welcome children over 10 years old

WATERSIDE

A modern luxury safari lodge that combines thatch, glass and steel. This spacious sanctuary brings a splash of colour to Royal Malewane.

- Sleeps 16 guests across four Luxury Suites, two Aloe Rooms and one Baobab Suite
- All suites enjoy direct access to Waterside's reception, dining areas, library, family games room, spa, gym and yoga room via illuminated pathways
- Guide's room available
- Outdoor bar
- Wine cellar
- Reflections Spa
- Children of all ages are welcome

MASIYA'S CAMP

Masiya's Camp offers a unique experience under canvas in an ultra-modern style, with every comfort one could imagine.

- Sleeps 12 guests across six Luxury Tented Suites
- All suites enjoy direct access to Masiya Camp's dining areas, boutique, pool and reception
- Communal bar and lounge
- Children aged 10 and above are welcome

Private Villa Options

AFRICA HOUSE

- Sleeps up to 12 guests
- A two-minute drive from Malewane Lodge
- Private services (private chef, host and private safari vehicle with a Guide and Tracker)
- Children of all ages are welcome

FARMHOUSE

- Sleeps 6 adults and 2 children
- Private services (private chef, host and private safari vehicle with a Guide and Tracker)
- Direct access to Farmstead and its facilities via illuminated pathways
- Children of all ages are welcome

WATERSIDE HOUSE

- Sleeps up to 8 guests
- Private services (private chef, host and private safari vehicle with a Guide and Tracker)
- Direct access to Waterside and its facilities via illuminated pathways
- Children of all ages are welcome