



DISCOVER SABI SAND NATURE RESERVE

# &Beyond Tengile River Lodge

Situated in a perfect position on the banks of the Sand River, with sweeping river views from every vantage point, lies Tengile River Lodge.



## DISCOVER THE SABI SAND NATURE RESERVE

&Beyond Tengile River Lodge

# Why stay?

## 1 PRISTINE LOCATION

The Sabi Sand Nature Reserve is one of the most prestigious wildlife sanctuaries in the world, with unfenced borders neighbouring the Kruger National Park, and is famed for its leopards and incredible wildlife. The uniqueness of the lodge is its ideal positioning on the Sand River with exclusive access to the riverbed.

## 2 ICONIC WILDLIFE

In addition to incredible leopard viewing, and the famous Big Five, discover a vast variety of plant and animal species that share the land with the Kruger National Park. Encounter a few of the over 500 bird species, 145 animal species, 110 reptile species and 45 fish species, that call this vast landscape home.

## 3 TRAVERSING RIGHTS

Tengile River Lodge has exclusive traversing rights on 10 500 hectares (26 000 acres) of wilderness land, which means our guests can explore the reserve on-foot, free from the constraints of roads and vehicles, go on a night drive, or sensitively go off-road enabling closer wildlife interactions.

## 4 SUPERB VIEWS

The lodge has been designed to ensure magnificent river views from all angles. Private decks and al fresco sitting areas are the ideal places to view wildlife using your SWAROVSKI OPTIK binoculars as herds of elephants congregate in the riverbed and game roam across the landscape.



Tengile River Lodge was just magnificent and totally exceeded all our expectations. ”

&BEYOND GUEST

## DISCOVER THE SABI SAND NATURE RESERVE

Beyond Tengile River Lodge

# Lodge amenities



# 1

### BOMA

After your evening game drive, enjoy a pan-African al fresco dinner under the stars and around the open blazing fire in the lodge's traditional boma.



# 2

### FITNESS CENTRE

Unwind in the well-equipped gym, complete with treadmills, a wattbike, yoga matts, exercise balls and static weights so that you can continue your training in comfort.



# 3

### HEALING EARTH TREATMENTS

Enjoy a relaxing Healing Earth spa treatment in the intimate massage sala where you can revel in a space of well-being and tranquillity with a glass of sparkling wine or a cup of herbal tea.



# 4

### SAFARI ACCESSORIES

Each cottage comes with a complimentary pair of SWAROVSKI OPTIK CL Companion 8x30 binoculars, for your use throughout your stay, as well as a take-home Guides' Journal featuring wildlife checklists and maps.



# 5

### SAFARI SHOP

Enjoy a visit to the lodge's beautiful Safari Shop where a range of premium, handpicked handicrafts and fashion showcases the very best facets of the region, including spectacular African jewellery, African Trade Beads Collection, and décor pieces.



## DISCOVER THE SABI SAND NATURE RESERVE

Beyond Tengile River Lodge

# Lodge amenities

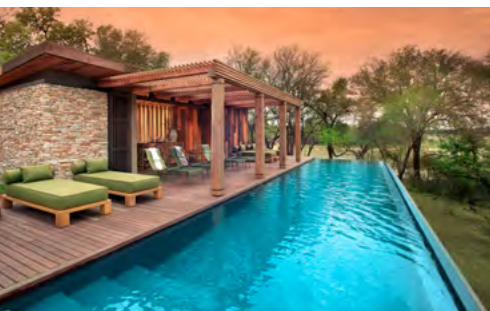

## 6

### SWIMMING POOLS

Not only does each suite boast their own private plunge pool with a view, but there is also a main lodge pool to be enjoyed near the spa where you can watch the herd of elephant roam by.



## 7

### FIREPIT

The firepit is another perfect place to gather after the evening game drive or after dinner. Sit around a crackling fire and unpack the day's events over a bottle of bubbly, or listening to tales of the bush from your guide with a steaming hot cappuccino.



## 8

### LIBRARY

The library is a unique and cosy spot in the lodge where you can cuddle up with an interesting book from the bookshelf, gather your family for a board game, or just potter around and observe the interesting old photographs and artefacts.



## 9

### BAR

The Tengile bar is certainly the heart of the lodge, with its unique design making it easy for all guests and staff to socialize after the days activities. Enjoy a selection of local craft beer or gin, while taking in the gorgeous view of the Sand River.



## 10

### INTERACTIVE KITCHEN

Tengile is known for its world-class dining experience. If you are up for it, join the chef around the interactive kitchen and enjoy a complementary cooking lesson.

DISCOVER THE SABI SAND NATURE RESERVE  
&Beyond Tengile River Layout

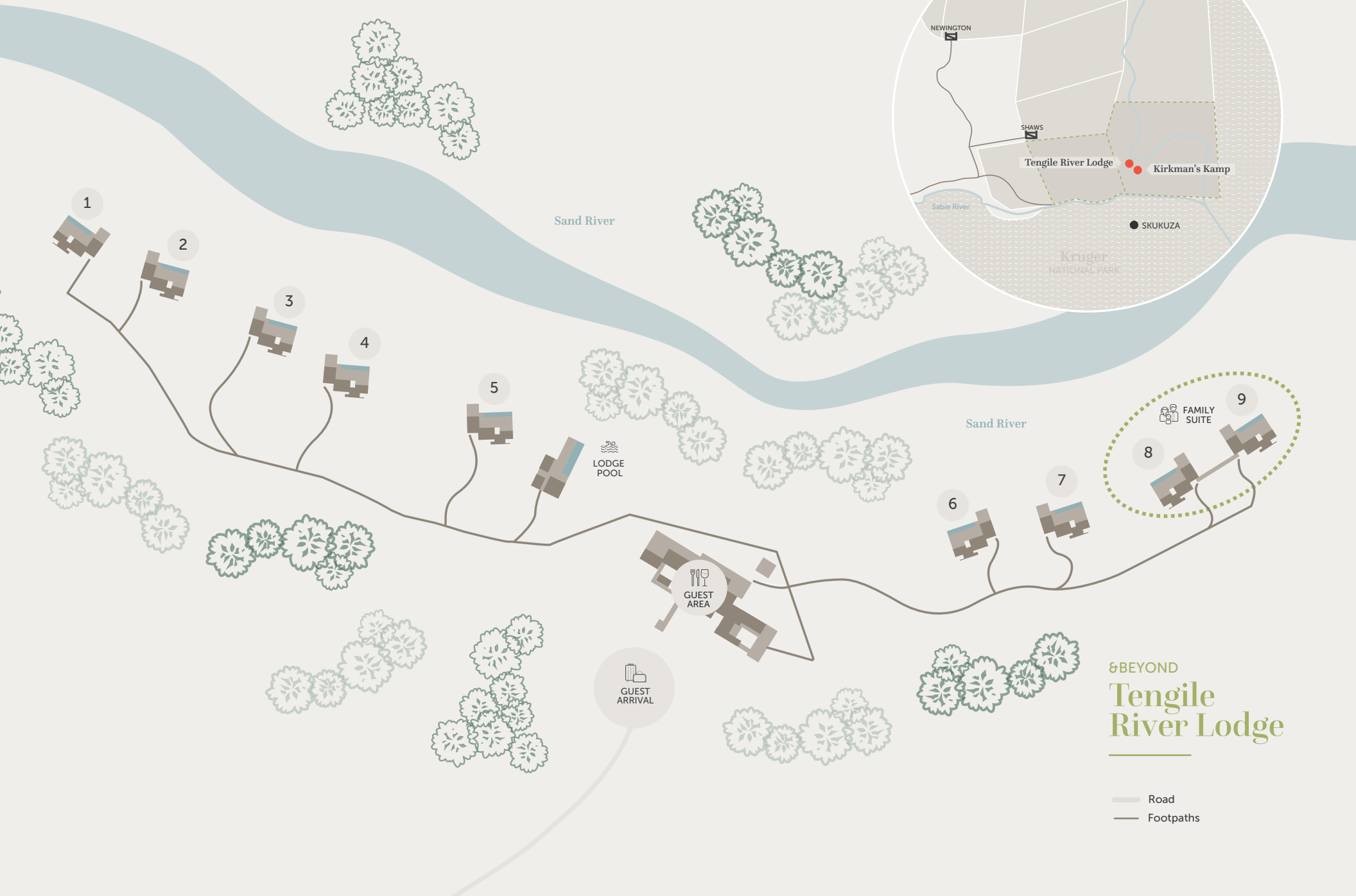

&BEYOND  
**Tengile  
River Lodge**

— Road  
— Footpaths

## DISCOVER THE SABI SAND NATURE RESERVE

&amp;Beyond Tengile River Lodge

# Lodge overview

## LODGE

Maximum number of guests	18
Number of suites	9
Suite types	9 Suites, including 1 Family Suite
Family accommodation	1 interconnected Family Suite with covered passageway (max. 2 adults and 2 children – 12-years and older only)
WILDchild programme	No
Pilot / Guide accommodation	Yes
Distance between suites	10 to 30 m (32 to 98 ft) between suites
Check-in and check-out times	14h00 / 10h00, with early check-in and late check-out on request
Lodge closure	Open year-round

## DINING

Food / Dietary options	Kosher and Halaal available upon request and at an additional cost Please advise the lodge in advance with at least four weeks' notice
Private butler service	Yes
Plated service	Yes
Private dining	Yes

## PAYMENT TYPES

Credit cards accepted	Visa, Diners, Amex and Mastercard
Currency	All major currencies accepted

## FACILITIES

Power	220v AC (50 Hz) plug points in rooms
Internet access	Yes, Wi-Fi in guest suites and guest area
Wine store or cellar	Wine store
Boma	Yes
Bar	Yes
Interactive kitchen	No
Swimming pool	Private plunge pools in each suites, plus a lodge swimming pool
Wellness offering	Yes, Healing Earth wellness treatments offered in-room or in the lodge's massage sala
Fitness	Yes, well-equipped gym
Conference facilities	No
Weddings & blessings	Yes
Wheelchair accessibility	Yes, with assistance Golf carts are available for guests with mobility issues
Complimentary laundry service	Yes
&Beyond Safari Shop	Yes

## OTHER

Vehicle type	10-seater open safari vehicle Max. six guests per vehicle
Private 4x4 safari vehicle	Yes, subject to availability and at an additional cost

DISCOVER THE SABI SAND NATURE RESERVE  
&Beyond Tengile River Lodge

# Inclusions

## RATE INCLUDES

Accommodation	✓
Three meals daily	✓
Soft drinks, house wines, local brand spirits and beers, teas and coffees and refreshments on game drives	✓
Laundry	✓
Safari activities	✓
One-hour nature walks accompanied by experienced armed trackers – subject to availability	✓
Emergency medical evacuation insurance	✓
VAT	✓
Transfers to-and-from Skukuza Airport	✓
One complimentary pair of SWAROVSKI OPTIK CL Companion 8x30 binoculars per suite to share during your stay	✓

## RATE EXCLUDES

Administration fee	×
Telephone calls	×
Safari Shop purchases	×
Gratuities	×
All items of a personal nature	×
Champagne, cognacs, fine wines, premium brand spirits and cigars	×
Government bed levy	×
Conservancy or park fees	×
Landing fees	×

**NOTE: Unmanned Aerial Vehicles:** Please be advised that the use of unmanned aerial vehicles (drones) are prohibited in the conservation areas we manage, until such time as their impact on wildlife and anti-poaching initiatives can be assessed. This rule will apply throughout Africa, as our partners in various countries and regions have adopted a similar stance.







&BEYOND

&BEYOND TENGILE RIVER LODGE

# Tengile suites





&BEYOND SOUTH AFRICA

DISCOVER THE SABI SAND NATURE RESERVE

&Beyond Tengile River Lodge Accommodation

# An indescribable haven

&Beyond Tengile River Lodge boasts nine enormous stilted Suites, each with 180-degree uninterrupted views of the Sand River.



LUXURIOUS BATHROOM WITH ALL THE AMENITIES



CONTEMPORARY LOUNGE WITH PERSONAL BAR



SPACIOUS DECK WITH PRIVATE POOL

DISCOVER THE SABI SAND NATURE RESERVE  
Beyond Tengile River Lodge Accommodation

SUITE

9 Suites / Max. 2 guests per Suite



IMMENSE LUXURY

This magnificent lodge features nine enormous, air conditioned, secluded suites, each with panoramic river views. In addition to a master bedroom, bathroom and outdoor shower, there is a lounge, dining area, fully-stocked bar, coffee station and outdoor area that is guaranteed to take your breath away. A private plunge pool on your spacious deck comes complete with sunken outdoor lounge looking out onto the famed Sand River.

ROOM FACILITIES

Suite sizes	204 m <sup>2</sup> (669 ft <sup>2</sup> )
Private veranda	Yes
Private plunge pool	Yes
Personal bar	Yes
Personal coffee station	Yes
Air conditioning / heating	Yes
Overhead fans	Yes
Mosquito nets	No, sealed room
Bath	Yes
Shower	Indoor and outdoor shower
Seperate WC	Yes
Telephone	Yes
Hairdryer	Yes
Internet access	Yes
In-room safe	Yes
Plug type	220V AC Plug Type C, D, M, N Adapters available
Triple bed option	No
Twin bed option	Yes, however, beds are within the same bedframe
Double bed option	Yes
Wheelchair accessibility	Yes, with assistance

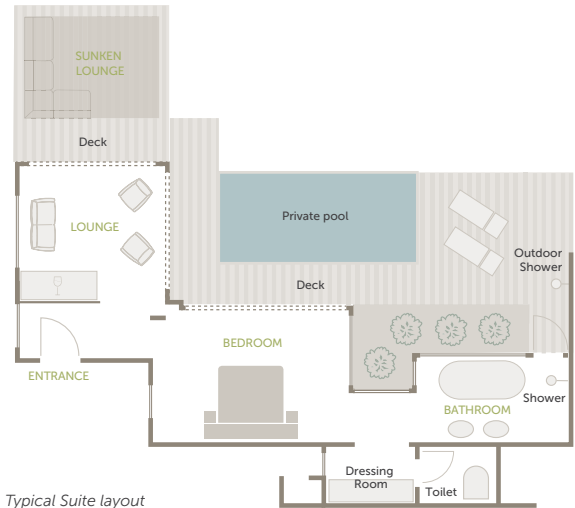

Typical Suite layout



DISCOVER THE SABI SAND NATURE RESERVE  
Beyond Tengile River Lodge Accommodation

FAMILY SUITE

1 interconnected Family Suite / Max. 2 adults and 2 children



Family Suite layout

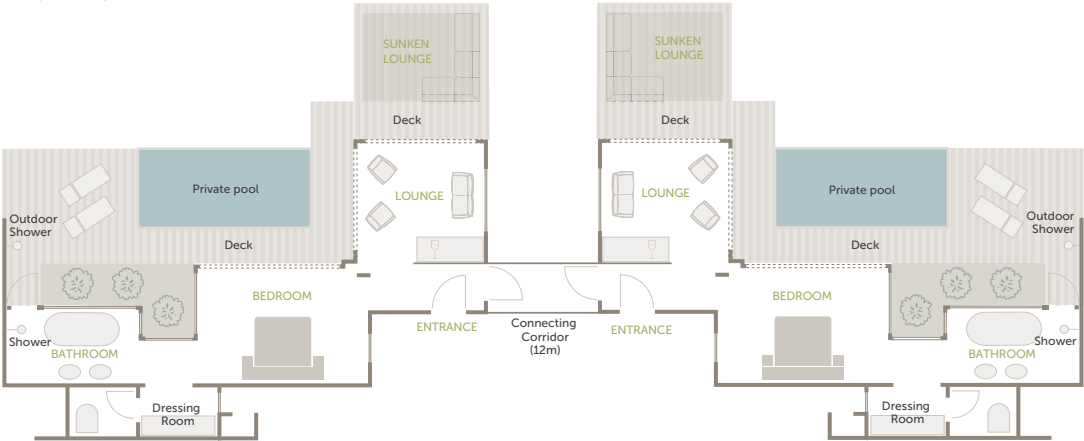

**LINKED IN EXCLUSIVITY**  
For families or small groups, two of the lodge's regular suites are joined by a 12 m (39 ft) covered walkway to create a Family Suite. Each suite has its own master bedroom that can be made into a double or a twin bed. The same bathroom and outdoor area as all the suites graces the two family rooms.

ROOM FACILITIES

Suite sizes	204 m <sup>2</sup> (669 ft <sup>2</sup> ) each – two suites
Private veranda	Yes
Private plunge pool	Yes
Personal bar	Yes
Personal coffee station	Yes
Air conditioning / heating	Yes
Overhead fans	Yes
Mosquito nets	No, sealed room
Bath	Yes
Shower	Indoor and outdoor shower
Seperate WC	Yes
Telephone	Yes
Hairdryer	Yes
Internet access	Yes
In-room safe	Yes
Plug type	220V AC Plug Type C, D, M, N Adapters available
Triple bed option	No
Twin bed option	Yes, however, beds are within the same bedframe
Double bed option	Yes
Wheelchair accessibility	Yes, with assistance





DISCOVER THE SABI SAND NATURE RESERVE

# Adventures of a lifetime

Encounter iconic wildlife on an &Beyond  
African safari, and enjoy an array of private  
and specialist experiences.





DISCOVER THE SABI SAND NATURE RESERVE  
Adventures of a Lifetime

# Experiences and highlights

In between your twice-daily game drives, why not take a nature walk with your guide, or indulge in a luxurious wellness treatment.



# 1

## SAFARI GAME DRIVES

Enjoy twice-daily game drives that set off early in the morning or late in the afternoon (continuing after nightfall) in the company of expert safari guides and local trackers who will do their best to ensure that all your wishes are met. In addition to the Big Five (lion, leopard, rhino, elephant and buffalo), each safari features an iconic set of wildlife and an opportunity to encounter the famous Sabi Sand leopard.



# 2

## NATURE WALKS

Experience a range of natural wonders in the company of your experienced professional guide on a nature walk. Learn how to track, seeing how close you can come to smaller game, such as impala and zebra, without them being aware of your presence. Each bush walk is accompanied by an expertly-trained and qualified guide, who follows strict protocols to ensure your safety and comfort.



# 3

## LOCAL COMMUNITY VISITS

A community visit provides a first-hand experience of the projects Wild Impact\*, our long-standing community and conservation development partner, is facilitating and supporting to enable future leaders, healthy ecosystems, future foundations and thriving communities. Visit projects in the Huntingdon and Justicia communities, such as the Happy Homes Preschool or nearby Madilika Craft Centre.

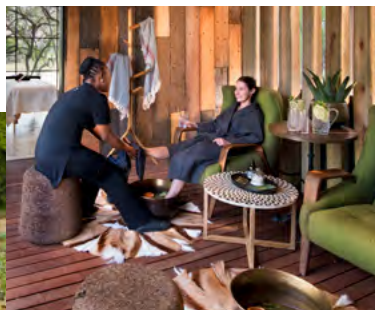

# 4

## WELLNESS TREATMENTS\*\*

After a safari-filled day indulge in the pleasures of a Healing Earth wellness treatment either in-room or in your lodge's tranquil spa or massage sala. &Beyond has partnered with Healing Earth, a leading natural, holistic spa and skincare company, to produce a truly authentic African spa experience for the mind, body and soul.



# 5

## WEDDINGS\*\*

From a classic safari wedding in the open bush to a sunset ceremony overlooking a spectacular view or a walk down the aisle in the dry bed of an African river, our meticulous wedding planners can put together a celebration filled with breathtaking moments and joyful surprises that will pamper and delight any couple.

\*Formerly Africa Foundation

\*\*These experiences and highlights are at an additional cost and subject to availability.

DISCOVER THE SABI SAND NATURE RESERVE  
Adventures of a Lifetime

# Specialist safaris and trips

When booking a private vehicle and specialist guide, our safaris can be tailor-made to suit a wide range of interests.



# 1

## SHANGAAN VILLAGE TOUR

Visit a Shangaan community, situated just outside Sabi Sand Nature Reserve, and interact with the friendly people of Mpumalanga. A Bantu tribal group, the Shangaan are the dominant group in the northeast of South Africa. A local guide will escort you through the village, sharing interesting insights and narratives about Shangaan culture, including its fascinating customs, beliefs and traditions.



# 2

## PRIVATE GAME DRIVES

A private safari game drive allows you to explore the concession at your own pace while focusing on your special interests. With your own dedicated ranger and tracker team, in your own private 4x4 safari vehicle, &Beyond's exclusive private safaris let you create your very own tailor-made wildlife adventure.



# 3

## FAMILY SAFARIS

The Sabi Sand Nature Reserve welcomes all ages, and is the ideal reserve for nature-loving families wishing to spend some much-needed quality time in the African bush. Tailor your safari experience to suit the whole family. Both &Beyond Kirkman's Kamp and Tengile River Lodge also feature a spacious Family Cottage and Family Suite respectively.



# 4

## BIRDING SAFARIS

Birding safaris are just one of &Beyond's many unrivalled specialist safaris that can be personalised for any small group. Accompanied by one of &Beyond's specialist birding guides, set out in search of over 300 bird species that inhabit the Sabi Sand, notable ones including the bateleur, black-bellied bustard and comb duck.



# 5

## WALKING SAFARIS

Dependant on the availability of a specialist guide, your ranger and tracker will tailor your walking experience to suit your personal requirements and preferences. Whether it be to follow a specific animal, unravelling the details of its daily life, or to spend the whole day exploring, a walking safari offers the opportunity to experience Africa at its wildest and most personal.



## DISCOVER THE SABI SAND NATURE RESERVE

Adventures of a Lifetime

# Year-round activities

- ✓ Big Five game viewing
- ✓ Private game drives\*
- ✓ Night drives\*
- ✓ Nature walks\*
- ✓ Specialist walking safaris\*
- ✓ Specialist family safaris\*
- ✓ Specialist birding safaris\*
- ✓ Local community visits
- ✓ Shangaan village tour
- ✓ Boma dinners\*
- ✓ Bush-dining\*
- ✓ Sundowners\*
- ✓ Wellness treatments
- ✓ Safari Shop
- ✓ Weddings

*\*Subject to availability of a private vehicle, specialist guide or tracker, or are weather dependent*



In terms of game viewing - dreams came true and we got stunning sightings of all the Big Five and mostly importantly the elusive leopard. ”

DISCOVER THE SABI SAND NATURE RESERVE  
Adventures of a Lifetime

# Timing is everything

	JAN	FEB	MAR	APR	MAY	JUN	JUL	AUG	SEP	OCT	NOV	DEC
<b>Tracking or walking safaris:</b> Winter – cooler walking conditions during the day					✓	✓	✓	✓	✓			
<b>Photography:</b> Summer – landscapes are lush and green with full watering holes and lots of animals	✓	✓	✓						✓	✓	✓	✓
<b>Night drives:</b> Summer – although offered year-round, the summer months are best as evenings are warmer	✓	✓	✓	✓					✓	✓	✓	✓
<b>Baby animals:</b> Summer – typically at the start of the rainy season	✓	✓									✓	✓
<b>Game viewing:</b> Winter to early spring – animals are known to gather around waterholes and are easier to spot in the thinned-out bush					✓	✓	✓	✓	✓	✓		
<b>Birding:</b> Year-round – however, if you'd like to see lots of birds then summer is best when the migrant birds return	✓	✓	✓							✓	✓	✓





DISCOVER THE SABI SAND NATURE RESERVE  
Adventures of a Lifetime

# A day in the life

OF A GUEST

From the moment you wake up, your &Beyond experience is tailored to your interests and needs. Your butler and guide will discuss the day with you, including times and experiences, to ensure your day is as extraordinary as the location you are visiting. Here’s what to expect on an average day on safari in the Sabi Sand Nature Reserve.

TIMING	EXPERIENCE
Early morning	Wake-up call from your butler, with a hot cup of tea or coffee
Early morning	Enjoy an early-morning health shot or warm drink, plus a treat, in the guest area before heading out on your morning safari game drive
Early morning to mid-morning	Morning safari game drive with coffee and tea stop and snacks
Mid-morning	Tuck into breakfast at the lodge
Midday to early afternoon	Go on a guided nature walk or local community visit
Early afternoon	Savour lunch at the lodge
Afternoon	Revel in a luxurious wellness treatment in the comfort of your room or the massage sala
Mid-afternoon	Indulge in afternoon High Tea at the lodge
Late afternoon	Afternoon safari game drive with sundowner stop and snacks
Early evening	Pre-dinner drinks and snacks in the lodge’s guest area, bar or around the firepit
Evening	Unwind after an eventful day with dinner at the lodge
Late evening	Discover the wilderness after dark on a night safari game drive

*Timings and guest experiences are guidelines only.  
All experiences are subject to availability and weather dependent. Some experiences are at an additional cost.*



## DISCOVER THE SABI SAND NATURE RESERVE

# Sustainability initiatives

In partnership with Wild Impact\*, our long-standing community and conservation development partner.



### CARE OF Land

- 53 362 Plastic water bottles eliminated per year by ♻️Beyond Mpumalanga\*\* lodges as a result of on-site bottling plants
- 40 000 Litres, daily average reuse of wastewater by our Sabi Sand lodges
- 100% of our ♻️Beyond Mpumalanga lodges have advanced wastewater treatment plants
- 5.4 Kg CO<sub>2</sub> per head reduction annually in our Mpumalanga region since 2018
- 98% Achieved by ♻️Beyond Ngala Private Game Reserve in an environmental audit conducted by the specialist Rhengu Environmental Services
- 18% improvement in ♻️Beyond Mpumalanga sustainability audit scores since 2016, highlighting a progressive reduction of our direct carbon footprint through a system of ♻️Beyond Group goals



### CARE OF Wildlife

- 64 Learners and teachers received conservation lessons in 2019, with the aim not only to educate, but also develop an understanding of the interdependence of conservation and community empowerment
- 25 200 Hectares of rich biodiversity significantly influenced by ♻️Beyond Ngala Private Game Reserve (14 700 Ha) and Sabi Sand Game Reserve (10 500 Ha)
- 414 000 ZAR contributed in annual park fees, July 2019 – March 2020
- 984 Leopard sightings documented by ♻️Beyond Sabi Sand guides in 2018 in collaboration with Panthera's regional leopard research programme



### CARE OF People

- 29 Years of compounded positive impact, across 23 local communities
- 50 Million ZAR annual disbursements to Mpumalanga communities, 2018 - 2020
- 55 % Local community staff to total employees at our ♻️Beyond Mpumalanga lodges
- 272 CLEF tertiary education bursaries granted to 206 young Mpumalanga leaders through this legacy-building Wild Impact programme
- 28 Million ZAR local-procurement spend by ♻️Beyond Mpumalanga, 2018 - 2020
- 17 Million ZAR social infrastructure investment in collaborative, community-led projects
- 3.2 Million ZAR donor funding for Bilton High School, Thlvekisa, close to ♻️Beyond Ngala Private Game Reserve, in a community project spanning 7 years



## DISCOVER THE SABI SAND NATURE RESERVE

# Travel South Africa and beyond

South Africa has an excellent travel network that makes it easy to reach any destination, by air or road.



## GETTING TO THE SABI SAND

Airlink offers daily scheduled flights from Johannesburg to Skukuza airport, which is followed by an easy 20-minute drive to the lodges.

Connect Sabi Sand Nature Reserve to Johannesburg, Cape Town, &Beyond Ngala Private Game Reserve, or the northern Sabi Sand Nature Reserve (Londolozi and Ulusaba). All flights route through either Nelspruit or Skukuza, where layovers vary.

Private charters from anywhere in South Africa can be arranged to the Sabi Sand Nature Reserve.

It is five-hour drive from Johannesburg on good roads in a two-wheel drive vehicle.

### TRAVEL TIMES

#### JOHANNESBURG

	5hrs 18mins (466.3 km) 2hrs 10mins (45mins layover)*	KRUGER NATIONAL PARK - NGALA PRIVATE GAME RESERVE			
	5hrs 22mins (452.1 km) 50mins*	2hrs 4mins (89.4 km) 45mins*	SABI SAND - SOUTH (SKUKUZA AIRPORT) - KIRKMAN'S AND TENGILE		
	6hrs 11mins (488.1 km) 2hrs 15mins*	1hr 18mins (46.8 km) 45mins*	1hr 51mins (80 km) Not available	SABI SAND - NORTH	
	6hrs 35mins (533.8 km) 3hrs 25mins (1hr 25mins layover)*	8hrs 48mins (657 km) 2hrs 10mins (20mins layover)*	7hrs 34mins (590 km) 3hrs 20mins (50mins layover)*	8hrs 40mins (636 km) 4hrs 45mins*	PHINDA
	14hrs 14mins (1 397.8 km) 2hrs 10mins*	19hrs 59mins (1 907 km) 3hrs 35mins*	19hrs 33mins (1 849 km) 4hrs*	20hrs 53mins (1 890 km) 4hrs*	20hrs 31mins (1 830 km) 4hrs 35mins (45mins layover)*
					CAPE TOWN

\*Airlink flights may include layovers ranging from 20-minutes to 2-hours depending on routing. Return flight times may differ for this reason.

## &BEYOND LODGES

- KRUGER NATIONAL PARK**  
Ngala Safari Lodge  
Ngala Tented Camp
- SABI SAND NATURE RESERVE**  
Kirkman's Kamp  
Tengile River Lodge
- PHINDA PRIVATE GAME RESERVE**  
Phinda Mountain Lodge  
Phinda Forest Lodge  
Phinda Rock Lodge  
Phinda Vlei Lodge  
Phinda Zuka Lodge  
Phinda Homestead

